



EARTH ENERGIES *and* GEOPATHIC STRESS

ALEX STARK

CREATING OUTSTANDING ENVIRONMENTS
WITH GEOMANCY & FENG SHUI

270 5TH STREET #1D, BROOKLYN, NY 11215

TEL. (718) 840-2820 FAX (718) 832-1787

WWW.ALEXSTARK.COM

Geopathic Stress (also known as geostress) is a form of trauma caused by disturbed or anomalous energies within the earth's mantle. The Earth is surrounded by an energy grid which contains and transmits vital forces. This grid is essential to life, and is part of the background radiation which supports life. However, this energetic grid can become traumatized and the energies which it contains and emanates can become harmful to life. Geopathic stress has been implicated in a number of undesirable effects to human health, from simple conditions such as sleeplessness or confusion to highly dangerous ones such as cancer, decreased fertility, and auto-immune dysfunction.

Western understanding of Geopathic stress, although still incipient, nevertheless recognizes a number of different causes for this perplexing phenomenon. Of the many possible scenarios, the most dangerous are the harmful underground water veins known as "black streams". These usually involve underground water streams that have become harmful due to human activities such as road cuttings, foundations, excavation, mining, explosions, war, and others.

In addition to geopathic stress generated by dark streams, other factors such as ley lines, global geomagnetic grid crossings, geological faults, underground caverns, and natural mineral concentrations all exhibit effects similar to black streams. They are all associated with geomagnetic anomalies, increased magnetic fields, and/or higher levels of radon gas. Lately, the entire spectrum of AC pulsed electromagnetic fields and industrial and medical ionising radiation sources have also been considered, as well as DC field disruptions caused by metallic objects such as reinforcing rods in cast concrete.

BLACK STREAMS

Black streams can be defined as underground water veins or streams that give off noxious radiations which can be harmful to life above them. They can be conceptualized as earth meridians (Mai) whose flow has become stagnant or polluted, giving rise to Negative Energy (Sha Qi). This Sha Qi includes radon gas as well as subtler elements.

Harmful radiation rises in a vertical plane from the underground stream to the earth's surface and above. Black Streams have been dowsed to be anywhere from 1 ft to 900ft deep and from 1ft to 300ft wide (the widest corresponding to a major ley line). The two edge lines and the centre line dowse as the strongest, sharpest Qi and are potentially the most dangerous places on the stream for habitual exposure. The streams may display tributaries and convergences, and dowsable echoes parallel to the main stream.

Black Streams have been known to change their habitual course, especially after earthquakes and droughts. They are known to be stronger at midday, mid-summer, full moon, and during periods of heightened solar flare (sunspot) activity. They have been dowsed as inactive in the Canadian tundra during the frozen winter. They are also known to be associated with higher levels of ionising radiation, and with lightning strikes and other atmospheric phenomena.

BLACK STREAMS: CAUSES

A black stream is a sick earth meridian (Lung Mai). There is a well-established link between black streams and traumas to the earth's etheric web that have caused the flow of Qi to stagnate in these channels. Typical examples of such traumas include the building of railway and highway cuttings, tunnels and embankments, quarries and mines, and building foundations, especially those with steel footings. Also implicated are heavy industry sites, power stations and electricity sub-stations, military bases, steel pilings, poles and even road signs. Old battle grounds and historical sites involving trauma to the earth or to humans, such as witch-burning sites, execution grounds, and burial grounds can also retain much Sha Qi. Sometimes natural topography can exhibit similar effects, particularly if there are concentrations of iron ore below ground.

On a subtler level, a contemporary real estate development which has been undertaken without any traditional ground-breaking rituals (i.e. without a foundation-stone laying ceremony or without offerings made in good faith to the earth and nature spirits whose land has been taken for development) can display signs of stagnant Qi in the earth meridians as well as traumatized elemental energies.

BLACK STREAMS: SIGNS AND SYMPTOMS

There are many well-documented medical effects of prolonged exposure to black streams, arising principally as a result of the position of the bed. Chinese and Western experience is similar in this respect. Most notorious of these medical effects is cancer. The first well-documented study of the correlation between geopathic stress and cancer was conducted in the 20's and 30's by the German dowser Baron von Pohl.

Von Pohl was asked to dowse the small town of Vilsbiburg in 1929, having then the highest

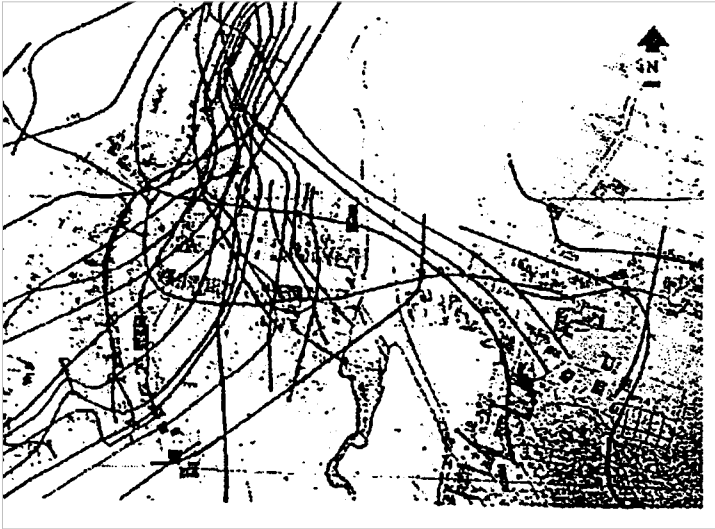

Baron Gustav
Freiherr von Pohl's
map of Vilsbiburg.

per capita cancer death rate in Bavaria at the time. He discovered a 100 per cent correlation between the beds of cancer victims and the paths of black streams passing through the town. He repeated the procedure in Grafenau in 1930, a town with the lowest cancer incidence in the province, and again found a 100 per cent correlation. He developed a scale to rate Geopathic stress of 1 to 16, where a combined tally of 9 or above gives rise to cancer.

Modern experience is that cancers of all types can grow where Geopathic stress is lower than this, possibly because we now have many more opportunities for

exposure to ionising radiation (for example through modern medicine), carcinogenic pollutants, and other assaults on the immune system.

Other diseases in which Geopathic stress has been implicated include: Multiple sclerosis, motor neuron disease, Parkinson's disease, and many other wasting and paralyzing diseases; endocrine disorders of all types; Crohn's disease; candidiasis; Down's syndrome and other congenital genetic disorders; schizophrenia and a host of mental disorders including obsessions, addictions, psycho-sexual disorders, suicides and location-specific depressions and anxieties.

Disorders which can have a Geopathic stress component include insomnia and nightmares, sudden infant death syndrome, infertility, myalgic encephalomyelitis (post viral fatigue syndrome), migraine, asthma, eczema, arthritis, and rheumatic disorders, and many other chronically depleted immune system conditions.

In terms of diagnosis for geopathic stress, it is believed in the acupuncture tradition that a point on the hand just distal to the fourth and fifth metacarpal junction (Triple Heater 3-1/3rd) is a prime Geopathic stress test point, for both diagnosis and treatment. Males often show pain if this point is pressed on the right hand, whereas females show weakness on the left hand.

ALEX STARK

feng shui

geomancy

shamanism

BLACK STREAMS AND THE ANIMAL WORLD

In the animal realm, most mammals instinctively avoid spending time over black streams, gravitating instead to white streams (i.e. the healthy, free-flowing earth meridians). Birds are reckoned to be most sensitive, and horses most resilient, though many injury-prone horses are often seen to be stabled on black streams.

On the other hand, cats, owls, snakes, slugs and snails are attracted to black streams, and a cat's favorite sleeping place (in the absence of an obvious source of warmth) is very often a sure clue to the location of a black stream crossing. Insects, parasites, bacteria and viruses also thrive on black streams, and ant and wasp nests invariably provide a similar clue. A black stream is also the perfect location for a beehive.

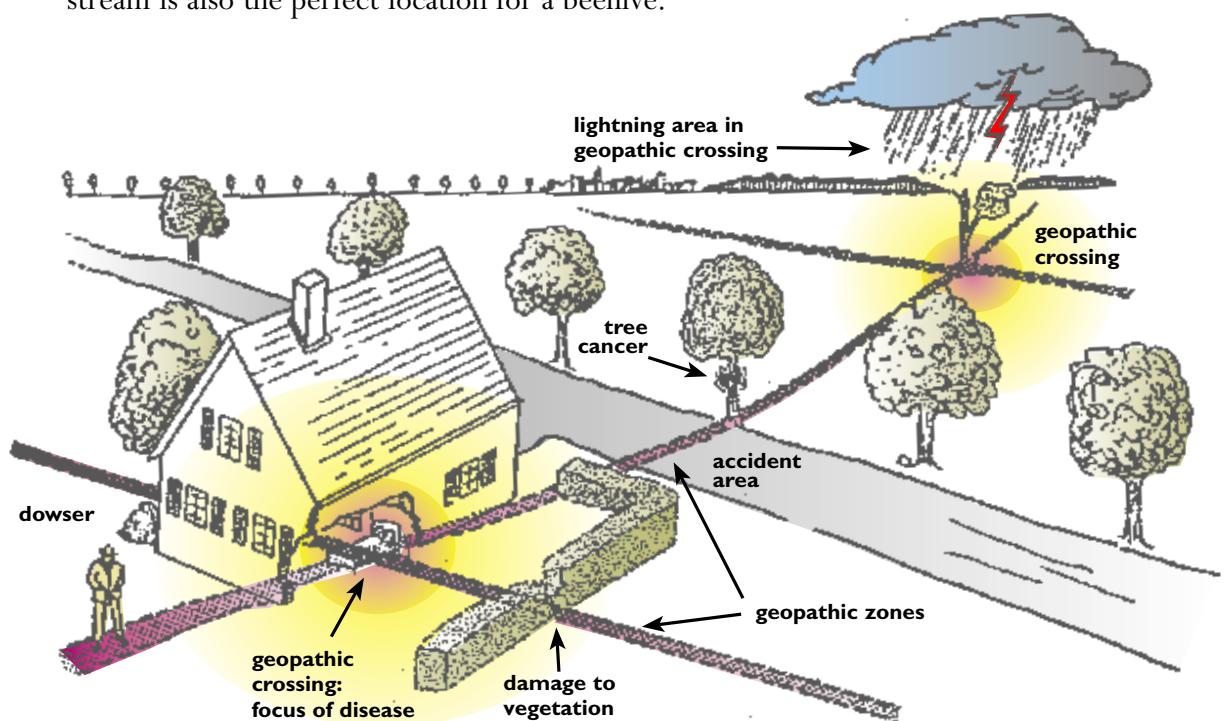

BLACK STREAMS AND THE VEGETABLE WORLD

Clues to the path of a black stream in the vegetable world include lightning-struck trees, dead or stunted gaps in hedges and avenues of trees, infertile fruit trees, cankers, and strangely twisted trees (usually in the direction of flow of the meridian current). Fruit trees are the most sensitive, while oaks, redwoods and ashes are more resilient, and elders seem to be positively attracted to dark streams.

Lawns will often betray bare patches, moss, silver weed and fungi. Vegetable gardens will reveal stunted or mutated growth, especially along the edge lines of the black streams. On the other hand, ivy, bindweed, nettles, docks, thistles, foxgloves, ferns and nightshades are

ALEX STARK

feng shui
geomancy
shamanism

naturally attracted to dark streams. In therapeutic terms it is believed that the appropriate medicinal herbs for a person who has fallen sick from a dark stream can be usually found in the garden along the path of a black stream running through their bed. This seems to echo homeopathic thinking.

OTHER CLUES TO BLACK STREAMS

The path of a black stream can often be traced within the home by following the piles of chronically unresolved clutter across a house. Other clues include piles of rubbish, cracks in glass, brick, sidewalks, and plasterwork, recurring mechanical and electrical breakdowns, derelict areas, and accident-prone “black spots” both within the home and outside of it. High accident locations on highways have also been correlated with geopathic stress activity. Fruit and vegetables, grain, ale, cheese, jam, wine, and photographic film will all spoil quickly when stored in the path of a dark stream.

Sick building syndrome, although a separate and distinct form of noxious imbalance, can sometimes be rooted in the presence of black streams under the property. In addition, Sha Qi can be spread from the path of the streams throughout the rest of the building by the steel construction frame, electrical wiring, and pipe work, just as it can be spread along railway tracks. Thus a steel-framed structure with black streams running through it will usually dowse positive more readily than a brick or wood structure under the same conditions.

Bad neighbor syndrome can sometimes be traced to a black stream flowing from aggressor to victim. Hauntings of earth-bound human ghosts and other entities, including poltergeist activity, are often tied to negative earth energies. Similarly, nature spirits and landscape entities, if not properly considered, can hold trauma to the earth's etheric web within the landscape.

LEY LINES

As mentioned above, in addition to black streams, there are other possible causes for geopathic disturbances. Ley lines are properly defined as straight over-ground energy lines that echo the sinuous paths of larger underground currents, including underground rivers. They carry positively charged Yang Qi and are a counterpart to the negatively charged Yin Qi of underground water. As such, they are associated with the Upper World in traditional societies, and are charged with Heavenly Consciousness. Because they act as a conduit for spiritual energies of various types, they are often referred to as “spirit lines”.

Ley lines have been recognized by all cultures as specially sacred and have often been chosen for the location of temples and other sacred structures and ceremonial sites. These straight spirit paths (often over dozens of miles) are found everywhere in the world, and frequently define the processional routes to major palaces, temples and cathedrals. Appropriate for

sacred sites and ritual ceremony, these energy pathways are less suitable for secular living, and houses built on them can become a thoroughfare for all manner of disturbances, including spirits. Hence they can become associated with Sha Chi and geopathic stress, and the energy they convey is often negative to humans.

Ley lines are found in all parts of the world, and have been developed in some societies to an extremely complex degree. The Inka, for example, have left evidence of a ley line system known as the *seques* which radiated from the center of the Inka empire in Cuzco to the four corners of the empire. The care and maintenance of these lines required vast investments of manpower and wealth and was of supreme concern for the state.

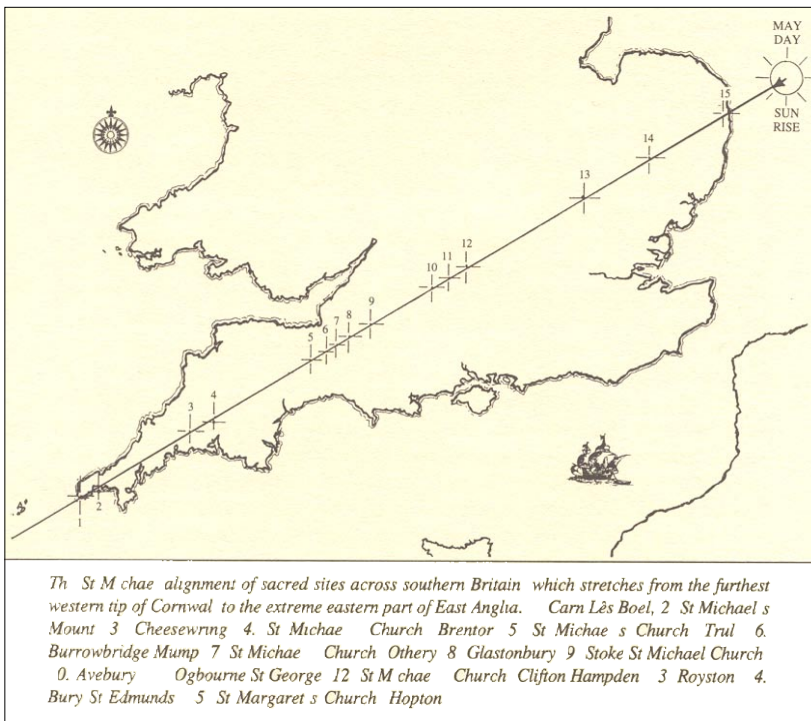

In England, dowsers have determined that the majority of ancient temples and holy sites, including Christian churches up to the 18th century, have been sited on such ley lines. The crossings of ley line systems, in particular, attracted wide attention and were celebrated with cathedrals, abbeys, and other markers. Recent research suggests that ley line systems may be global and extend across whole continents. One such system has been described as connecting the sites of Avalon in England with the temples of Delphos in Greece. Unfortunately, we ignore these brilliant elaborations of Earth energy to our peril, as the path of ley lines, despite their usefulness as spiritual markers, can often be too strong to support successful human use. Structures unwittingly located above them can derive some of the same complications already mentioned for dark streams.

ALEX STARK

feng shui
geomancy
shamanism

RADON GAS

The earth's natural background radioactivity is concentrated along certain geological faults, mineral veins, and water-bearing fissures. The ultimate source of radioactivity on earth is uranium-238, created from lighter atoms inside supernovas billions of years ago. The uranium-238 atoms, with 146 neutrons, are constantly reverting to more stable configurations with fewer neutrons by emitting an alpha particle from the nucleus quickly followed by two electrons. Once they have started to decay, uranium-238 atoms produce a chain of 'daughters', including radium-226, the 'parent' of radon-222. Radioactive radon gas rises to the surface and emits harmful alpha radiation which builds up to dangerous levels in poorly ventilated places such as buildings.

Geopathic stress theory is primarily concerned with radon-222 which has 86 protons, 136 neutrons, a half-life of 3.8 days, and decays to polonium-18 by shooting off an alpha particle, a process which may occur within our lungs. The newly formed polonium atoms quickly decay to other 'daughters': as these decay each atom first ejects another alpha particle, and then a series of high-speed electrons, high-energy gamma rays and fast neutrons. The alpha particles bombard cells directly; most gamma rays and fast neutrons pass right through our bodies though some score bull's-eye hits on atomic nuclei within us.

Since the mid 1980's the US Environmental Protection Agency and the UK National Radiological Protection Board have conducted new national surveys of radon levels in houses. Before these surveys most specialists thought the problem was confined to small areas of uranium-rich rocks, such as granite. The new surveys suggested that in one in eight American homes, people were breathing air dangerously contaminated by radon; in the UK, 90,000 homes contained air contaminated to a level of 200 becquerels per cubic metre or more and were therefore receiving yearly radiation doses of at least 10 millisieverts. The current BNFL maximum permitted dose is 15 millisieverts per year; the NRPB's work suggests that at least 100,000 British people receive more than this.

The accumulation of Radon gas is accentuated by inadequate ventilation in modern houses; the more so with underfloor service conduits, central heating, draught-proofing and double-glazing, causing the air pressure within the house to be slightly lower than outside.

The provision of adequate ventilation within a building is one answer to the problem. This can be achieved by positive ventilation fans blowing air from the attic or outside into the house, to raise internal air pressure; by sealing floor boards and installing under-floor air bricks; or by installing a radon sump system to draw air from the soil beneath the house and redirect it outside.

ALEX STARK

feng shui

geomancy

shamanism

GLOBAL GEOMAGNETIC GRIDS

Global geomagnetic grids, of which there are several, are thought to arise from the earth's magnetic field as a form of vertical, and sometimes horizontal, radiation. They follow laws of symmetry and direction, lining up with regularity at constant inclinations to the earth's magnetic axis. Researchers have found that the grid lines can cause changes in the earth's magnetic field, the electrical conductivity of the ground, variations in ultra short wave receptions, increases in positive ions, differences in blood sedimentation rate, and at times increased gamma radiation.

The grids are at their strongest between 12:00 midnight and 3:00a.m. and at their weakest at 5:00p.m.; they are influenced by earthquakes and weather conditions, and are weaker in fog; they do not rise vertically but at an angle which can change a few degrees during the night; and, unlike underground streams, they are not influenced by phases of the moon. In addition, they show varying weak zones of resonance (echoes) outside the main line.

In the Stone Age standing stones were set up on grid line crossings; the Chinese, Indian, Greek, Roman and European Medieval civilizations knew of them, as the location of temples, monuments and cathedrals bears witness.

I. THE HARTMANN GRID

This was described by Dr. Hartmann in the 1960's. The network appears as a structure of radiations rising vertically from the ground like invisible radioactive walls. From north to south they are 25cm. wide and encountered at constant intervals of 2m., while from east to west they are 15cm. wide and the distance apart varies according to latitude from 1.2m. in Reykjavik, Iceland (63.36"N) to 2.06m. in Ried, Switzerland (40.50"N).

Between these geometric lines lies a neutral zone.

The north-south rays are Yin and linked to humidity, cramps and all forms of rheumatism.

The east-west rays are Yang and are linked to inflammations.

Wherever two rays cross (a "Hartmann Knot") a geopathogenic point is found. This is especially so at crossings of double negative lines which repeat at approximately 35m. intervals.

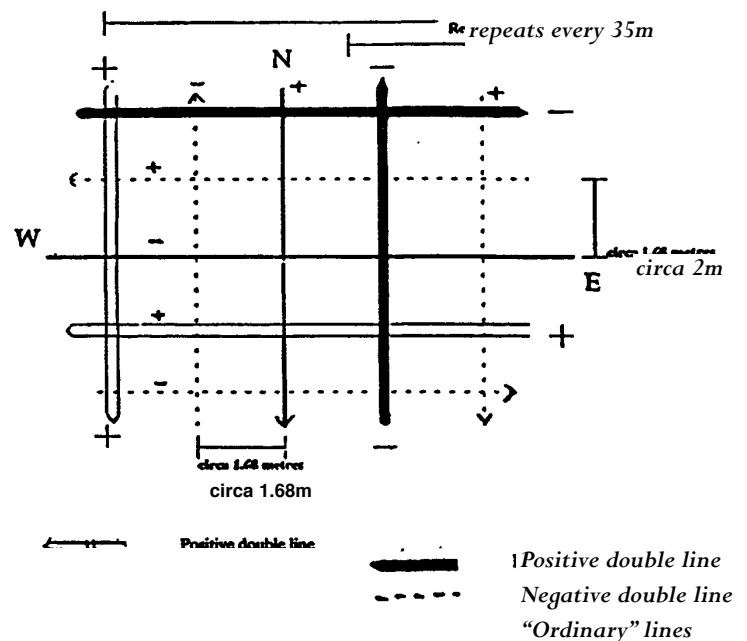

ALEX STARK

feng shui
geomancy
shamanism

Sleeping over these knots can cause nervous disturbances, headaches, cramps and rheumatic illnesses. Where the intersections coincide with black streams the effect is greatly increased

The intensity of these lines increases three to four-fold at night when there are less free ions (for similar reasons radio waves are received better at night). Twenty-four hours before the arrival of an atmospheric low pressure zone, a 100% increase of gamma rays is found on the knots (up to 300% on volcanic soil).

Twelve hours before an earthquake the thickness of the ray triples: beside the central ray appear two other weaker rays to left and right which are not normally detectable. At this time dogs howl, birds flutter madly in their cages, some cats hide under the quilt, and some people feel sick or need to sleep. During an earthquake the Hartmann network becomes twisted and distorted, but is restored to symmetry half an hour later.

This network penetrates everywhere in dwellings or on open ground, but Merz has found the grid to be pushed outside certain sacred structures such as the Egyptian pyramids or temples as well as Himalayan Buddhist stupas. These structures seem to create a dense protective perimeter composed of up to seven rays around the perimeter, and a ray-free interior.

2. THE CURRY GRID

This grid, described by Wittman and Curry in the 1970's, has much in common with the Hartmann grid, but is oriented 45° from north. The south-west to north-east grid lines repeat every 2.36m, and the south-east to north-west lines every 2.7m. The lines are approximately 15cm. wide, with medically significant double nega-

tive lines repeating every 50m. Crossings of these lines are considered more harmful than the equivalent Hartmann knots.

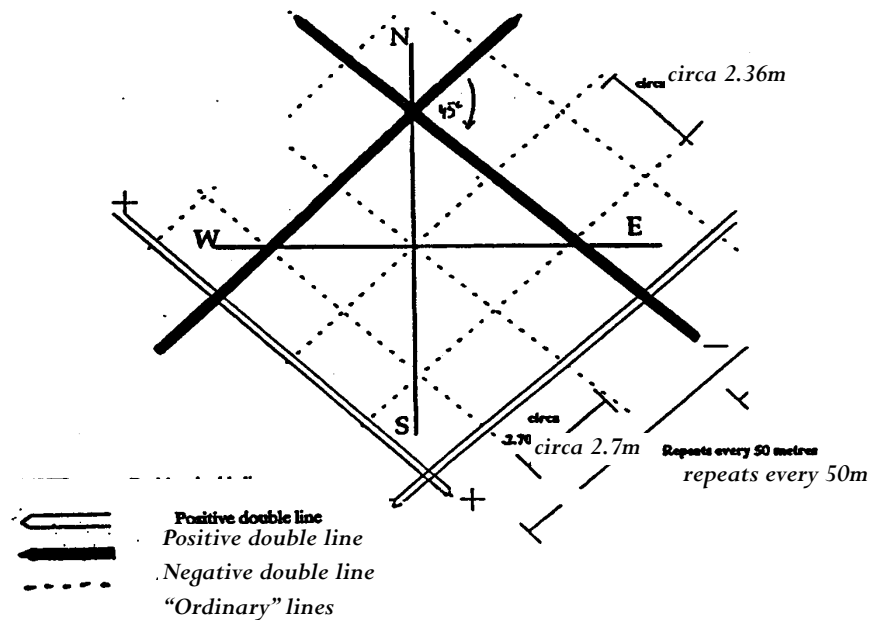

The double negative crossings are associated with sleep disturbances, depression, and other nervous reactions, inflammations and rheumatic diseases; and also with the sites of stocks and pillories, and hellebore plants. Double positive crossings encourage enhanced cell enlargement and proliferation, even to the point of cancerous growth.

ALEX STARK

feng shui

geomancy

shamanism

3. THE SCHNEIDER GRID

This was described by Schneider in the 1980's as a positive grid, oriented 45° east of north with lines 17cm. wide, a repeating interval of 294m, and a north-south and east-west energy flow. The lines of this grid are supposed to increase powers of thought and speech, and pulpits and lecterns are often found on its crossing points.

Schneck described a mirror image negative version of this grid, oriented 45° west of north, and with the opposite energy flows and mental effects.

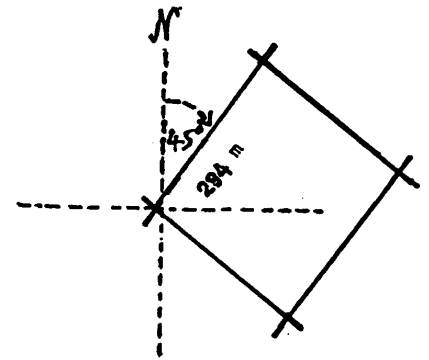

4. THE SECOND SCHNEIDER GRID

Schneider also described a positive grid oriented 28° east of north with lines 21cm. wide and a repeating interval of 267m.

Hawthorns like to grow on the lines of this grid, which are associated with strength and physical healing, and are often followed by stretches of Roman roads. On its lines crossings are found holy wells, chapels, shrines, way-side crosses, stone-age camps and castles, Roman forts, standing stones and cup-stones. Especially powerful lines occur, and Chalice Well, Glastonbury is on such a crossing.

Schneck again describes a mirror-image negative grid.

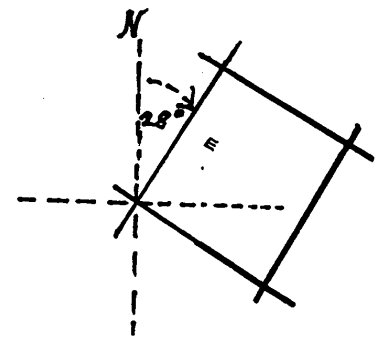

5. OTHER GLOBAL GEOMAGNETIC GRIDS

In addition to the global geomagnetic grids mentions above, there are many others, of which the most important are the Broad Curry Grid, the Double Curry Grid, and Schenck's Cemetery Grid. The positive lines in these grids are all associated with dolmens, stone circles, ancient sites, holy wells, chapels, and holy trees. Their negative counterparts, similarly, are associated with prisons, execution sites and, where they converge with other negative lines such as black streams, "cancer points" can be found.

CURES TO GEOPATHIC STRESS

There is much that can be done to ameliorate or remove Geopathic stress. Traditional Chinese devices include the building of a Dragon wall (a screen wall with an undulating ridge), placing of mirrors in specific patterns, the digging of a ditch, or the burying of a protective talisman at an appropriate point on the path of the stream.

To cure a black stream the Sha Qi (negative energy) of the affected meridian can be transformed into Sheng Qi (positive energy) by the practice of Earth Acupuncture. This can be performed using wood, metal, stone, or crystal "needles" applied to the appropriate earth acupuncture points (Xue) for a variable time, perhaps as briefly as for a few seconds, but on average for about two hours. The black streams are thus transformed into white streams. With larger meridians, or with geological faults, a needle may need to be left in place permanently. Fire, in the form of candles, incense, moxa, sage, or a bon-fire may also be employed. The old Beacon hills of Britain are moxibustion points in the landscape for the purification of the land. They are fired at the appropriate moments in the cycle of the seasons. In time these became the fire festivals.

Permanent needles may take the form of moving water features, sculptures and statues, standing stones, stone cairns (piles), stupas, or a specially planted tree. In this sense, a grave stone may be seen as a form of earth acupuncture needle which balances the Yin Qi of the corpse with a Yang sculptural form to reunite the Qi of Heaven and Earth. On a larger scale, pagodas, temples, churches, and cathedrals can all function as earth acupuncture needles.

Earth acupuncture which has been used to promote the flow of Qi in a blocked meridian under a house will generally have an instantaneous effect in dispelling an accumulation of radon. Where the radon concentration derives from black streams the effect is usually permanent as long as the streams remain white. Where radon derives from geological faults it will generally build up again, and more permanent physical remedial action is necessary.



ALEX STARK

feng shui

geomancy

shamanism

Inserting acupuncture "needles" against geostress: rock quartz in a foundation slab (left) and a laser-cut Vogel crystal in reinforcing foundation bars within poured concrete.

Modern Western methods include the careful placing of crystals, copper coils, and rods as well as the installation of radionic devices such as the Raditech, Helios 1, and Total Shield machines. These are all resonators which attempt to replicate the normal background radiation of the earth (the Shumann wave) at 7.8 Hertz. By comparison, geopathic stress zones often exceed 200 Hertz, and have been measured as high as 250 Hertz.

What all these cures have in common is a therapeutic intention, often in a sacred ceremonial context. Cures to Geostress have to be performed within a sacred ritual context, because it is only through the use of ritual that the energies of the Earth can be made to shift. All traditional peoples have recognized this fact. In many cultures stone piles, standing stones, or specially designated trees are used to both cure the geopathic stress as well as to create a secondary and more beneficial effect through the use of prayer, meditation or shamanic trance. Usually the spirit world is addressed directly. Training for geopathic cures therefore invariably involves spiritual education at an advanced level.

ALEX STARK

feng shui

geomancy

shamanism

RESEARCH INTO GEOPATHIC STRESS

The Bibliography at the end of this paper contains references to most of the available research on this topic. However, a brief overview of the field would have to include the following:

Baron Gustav von Pohl. Germany (1920's)

Von Pohl was able to determine that 2.5 of all the homes surveyed had some form of geopathic stress. He also determined that 95% of all cancer cases had connections to geostress.

Ernst Hartmann. Germany (1940's-60's)

Hartmann was the first to describe the global geomagnetic grids and their influence on geostress. After extensive testing that spanned over 30 years of research, he concluded that cancer is a disease of location.

Manfred Curry. Germany (1950's-70's)

Curry continued on Hartmann's work, describing other global grids and their influences.

Blanche Merz. Switzerland (1920's)

Merz was able to correlate geostresses to cancer, noting full moon variations, as well as correlations of north/south lines to cramps and rheumatism, and east/west lines to inflammation.

Ralf Gordon. England (1980's-90's)

Gordon correlated cancers of the lung, breast, and cervix with geostress in 90% of all cases.

Otto Bergmann. Austria (1987-89)

In a two year trial which included over 462,000 measurements in 6,942 tests, Bergmann found geopathic stress effects on blood sedimentation, blood pressure, blood circulation, heart beat, breathing, skin resistance, and electrical conductivity of muscle points.

Kathe Bacheler. Austria (1989)

In a survey that included 3,000 apartments and over 11,000 people, Bacheler discovered 100% correlations between geopathic stress and 500 cases of cancer she studied. She also found 95% correlation with "problem" children.

Eugene Pallegard. Denmark (1990)

In a much publicized study, Pallegard correlated geostress in 14 out of 18 crib deaths.

Roger Rose. England (1990's)

In a sample of 50 patients with myalic encephalomyelitis, Rose found 100 % correlation to geostress.

Christopher McNaney. England (1990's)

In a sample of 175 nomadic gypsy families, he found only 1% cancer and 0% heart disease.

Robert Endrost & Klotz Biberach. Germany (1990's)

In a study performed by architectural students surveying homes, Endrost & Biberach found

BIBLIOGRAPHY

- Kathe Bacheler, *Earth Radiation*, Wordmasters, Manchester, 1989
- Paul Broadhurst & Hamish Miller, *The Dance of the Dragon*, Pendragon, 2000
- David Cowan & Rodney Girdlestone, *Safe as Houses: Ill Health and Electro-stress at Home*, Gateway, 1996
- Paul Devereux, *Places of Power*, Blanford, 1990
- Paul Devereux & Ian Thomson, *The Ley Hunter's Companion*, Thames & Hudson, 1979
- Emoto, Masaru, *Messages from Water*, Beyond Words Publishing, 2004
- Ralf Gordon, *Are You Sleeping in a Safe Place?*, London, 1990
- Tom Graves, *The Diviner's Handbook*, Turnstone, 1978
- Tom Graves, *Needles of Stone*, Destiny Books, 1990
- Freiherr Gustav von Pohl, *Earth Currents as Pathogenic Agents for Illness and the Development of Cancer*, Frieich Verlag, Feucht, 1983
- Christopher Bird, *The Divining Hand*, Dutton, 1979
- Richard Fortey, *The Hidden Landscape-A Journey into the Geological Past*, Pimlico, 1993
- Derham Groves, *Feng Shui and the Western Building Ceremonies*, Brash, 1991
- Alan Hall, *Water, Electricity and Health*, Hawthorn, 1997
- Ernst Hartman, *Krankheit als Standortproblem*, Heidelberg: K.F. Haug-Verlag
- Julian Kenyon, "Bio-Energetic Regulatory Medicine", *International Journal of Alternative and Complementary Medicine*, July 1992
- Koenig, Krueger, Lang, and Soenning, *Biologic Effects of Environmental Electromagnetism*, Springer, 1981
- Sig Lonegren, *Spiritual Dowsing*, Gothic Image, 1986
- James Lovelock, *Gaia: The Practical Science of Planetary Medicine*, Giaa Books, 1991
- Blanche Merz, *Points of Cosmic Energy*, Daniel, 1987
- Blanche Merz, *Telluric Rays and their Influence on the Living World*, Institut de Recherches en Geobiologie, Chateau de Chardonne, 1974
- John Michell, *The Earth Spirit*, Thames & Hudson, 1975
- Hamish Miller & Paul Broadhurst, *The Sun and the Serpent*, Pendragon, 1989
- Nigel Pennick, *Lines in the Landscape*, Hale, 1989

Nigel Pennick, *The Ancient Science of Geomancy*, Hale, 1980

Marko Pogacnik, *Nature Spirits & Elemental Beings*, Findhorn, 1995

Dr. G. Schneek, *Global Grid Lines* in the *Journal of the British Society of Dowsters*, June 1995.

Cyril Smith, 'High Sensitivity Biosensors and Weak Environment Stimuli', *International Industrial Biotechnology*, April/May 1986

Dr. Glen Swartwout, *Electromagnetic Pollution*, Aerai, 1991

Jane Thurnell-Read, *Geopathic Stress--How Earth Energies affect our lives*, London, 1998

Tom Williamson, *Dowsing*, 1993, Ch.3

www.earthtransitions.com

www.naturalchoice.net

www.layman.demon.co.uk

www.neholistic.com

www.healthk.co.uk

www.alivewater.net

ALEX STARK

feng shui

geomancy

shamanism